

# SM-26(BLACK)

**26KG/24HR PLUMBED-IN  
BULLET TYPE ICE-MAKER  
BLACK**

**PRODUCES:  
BULLET ICE**

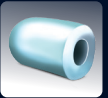

**Dimensions (mm) Unit:  
(H) 655 (L) 425 (W) 540**



**Storage Bin Volume:  
6Kg**



**Ice Making Capacity:  
26Kg/24Hr**



**Net Weight:  
33Kg**



**Voltage:  
230V/50Hz**



**Rated Current:  
1.1A**



**Total Input Power:  
300W**



**Adjustable Feet:  
+/- 20mm (H)**



**COLOUR:  
MATTE  
BLACK**

## FEATURES

- ✓ Ice Type: Bullet Ice
- ✓ Bullet Ice Size (mm): (H) 36 (W) 26
- ✓ 16 Ice Bullets Per Cycle
- ✓ 6Kg Ice Storage Bin
- ✓ External LED Display With On/Off Switch
- ✓ Ice Full Sensor
- ✓ Water Low Sensor
- ✓ Includes: Ice Scoop, Disposable Water Filter Cartridge, Inlet and Outlet Pipes
- ✓ Engineered For The African Climate

*Note: We recommend a certified plumber installs your plumbed-in ice-maker. These units have a gravity-fed drain point, thus the drain point must be lower than the ice-maker. Ensure to keep the unit well ventilated and clean the condenser regularly. \*To maximize the ice-making performance of your plumbed-in ice-maker, it's ideal to have it in a steady environment with a 20°C ambient temperature and 10°C water temperature. While your ice-maker can handle higher temperatures, these conditions ensure peak production capacity. Adjustable Leveling Feet (+/- 20mm)*



**Suggested Applications: Office, Home Bar/Kitchen, B&B, Pub, Gym, School**



1-YEAR WARRANTY ON PARTS NOT LISTED

Scan QR Code For  
More Information

